



Drain Basin Order/Quote Form

www.gpk-fargo.com

(For Submittal Information and dimensional data visit our website)

PO#: _____ Date: _____ Quote#: _____

Sale Order _____ Job Name & Location: _____
 (To be Assigned by GPK)

Company: _____

Contact: _____

Address: _____

City: _____ State: _____ Zip: _____

Phone: _____ Fax: _____ Email: _____

Signature: _____

Drain Basin Size: _____

Drain Basin Height (A): _____

Grate Type: _____

Grate Style: _____

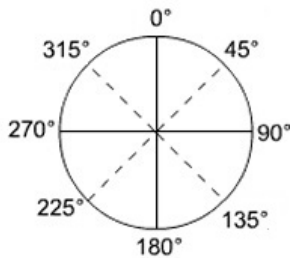

Notes

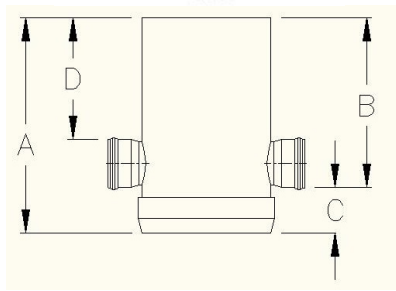

Outlet #	Size	Outlet Type	Pipe Manufacturer	Position (Degrees)	Invert Height (B)
1					
2					
3					
4					
5					
6					

**Minimum Top of Outlet to Top of Basin (D)
Minimum Sump Depths (C)**

Refer to Chart for Minimum Angle Between Outlets.

Basin Size	Minimum
8"	6"
10"	6"
12"	6"
15"	6"
18"	6"
20"	8"
24"	8"
30"	10"

Outlet Types

YG	C900 Gasketed	JM	JM Eagle Corrugated
YH	C900 Solvent Weld	PR	Prinsco Corrugated
PG	PSM Gasketed	UR	Ultra Rib
PH	PSM Solvent Weld	UC	Ultra Corr
IG	IPS Gasketed	C2	Corr21
IH	IPS Solvent Weld	P2	Pro21
AD	ADS Corrugated	VY	Vylon
O	Other		

Grate Types

Round W/Frame (8" - 30")
Drop In (8" - 30")
Domed (8" - 30")
Domed W/Frame
Square Hinged (12" & 15")
Curb Inlet 2'x2' & 2'x3'
Traffic 2'x2' & 2'x3'

Grate Style

H-10
H-20
Solid

* D & C Dimensions are the Same

Note: Basins Over 8' Use Coupling

* All Drain Basins are Non-Returnable and Non-Cancelable Upon Beginning of Production.

* All Joints are Water Tight.

* A dimension is overall height without grate.

* Drain Basins are to be made of PVC PSM/PS46.

1601 43rd Street North • Fargo, ND 58102
 Phone: 701-277-3225 Toll Free: 800-437-4670
 Fax: 701-277-9286 or 800-822-6989